

LP16 Series

IP68 Compact Quick Connect Plug & Sockets

The compact LP16 circular connectors (part of the LP series) feature a high-precision, key-way pluggable design with integrated self-locking, push-lock and quick release mechanism. Supplied in a variety of PBT plastic and Zinc alloy metal housings, they are Rated IP68 waterproof along with UV resistant properties. Supporting power or signal transmission they are ideal for demanding environments and well suited for use in aviation, communications, renewable energy, medical, robotics, automation, industrial appliances, LED displays and many more applications. The wider product family includes additional sizes LP12, LP20, LP24 and LP28 with higher electrical ratings, alongside fibre optic, HDMI, RJ45 and USB-A/USB-C connection options.



- 2 to 9 pin for power and signal applications
- Supplied as mating pairs for value and convenience
- IP68 1m / 2hr when mated (IP65 with cap)
- PBT Plastic / Zinc Alloy & PBT Plastic / Zinc Alloy
- PBT material is UV resistant and flame retardant
- Screw and solder options up to 10A / 400V
- Cable, panel and flange mount types
- Dust cap included with panel mount types
- Cable range 4 - 9 mm
- Quick connect, push fit, press to release - anti-vibration
- Maximum housing diameter 32 mm
- Gold plated contacts
- UL, ENEC, CE approvals

Specifications & Materials:

Unit of Supply	Male & Female pair (Panel / Flange & silicon dust cap)
Number of Pins	2 - 9 (note: 6-pin not available)
Connection Type	Screw (2 - 5 pin only) or Solder (all configurations)
IP Rating	IP68 to 1 m / 2 hr (IP65 panel with dust cap)
Voltage	400V (2 to 4 pin) / 250V (5 to 9 pin)
Current Rating	10A (2 to 4 pin) / 5A (5 to 9 pin)
Wire Size	1.5 mm ² (2 to 4 pin) / 0.5 mm ² (5 to 9 pin)
Mating Cycles	>1900
Material	PBT plastic (flame & UV retardant) / Zinc alloy.
Panel Cutout	18.5 mm
Cable Diameter	4 - 9 mm
Temperature Rating	-40°C to +85°C
RoHS Status	Compliant
Approvals	UL, ENEC, CE

LP16 Series

IP68 Compact Quick Connect Plug & Sockets

Material Types & Configurations

Cable to Cable



Cable to Flange



Cable to Panel



Cable to Cable (male)

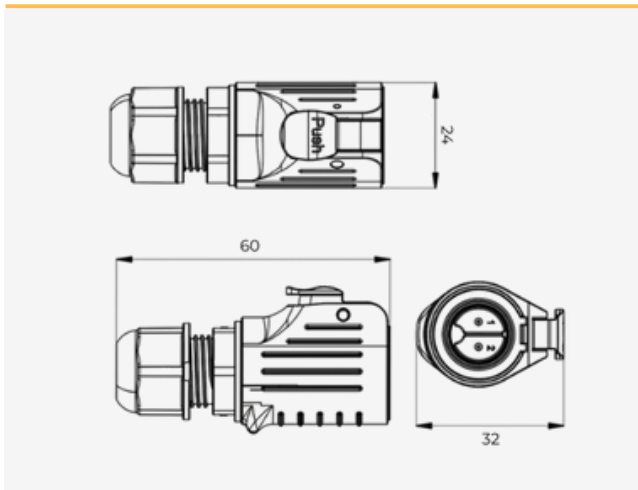

Cable to Cable (female)

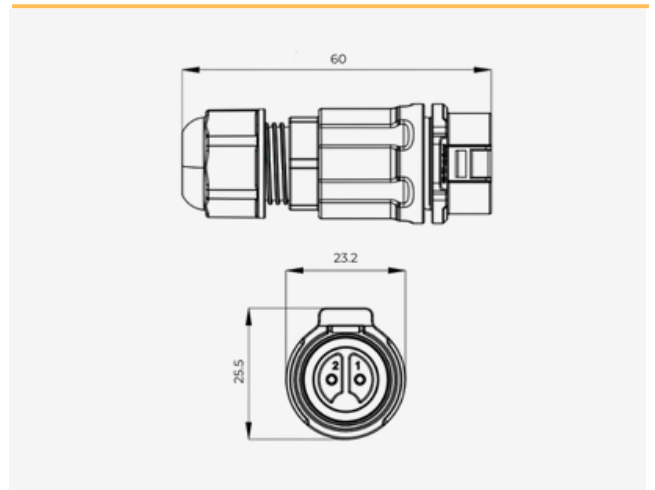

Panel Mount (female)

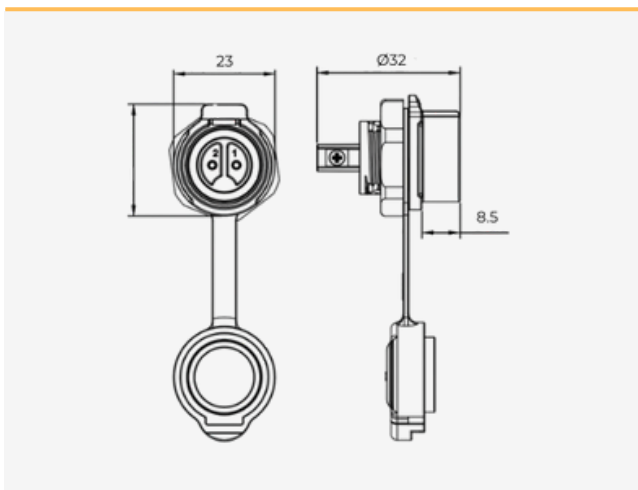

Panel Mount Flange (female)

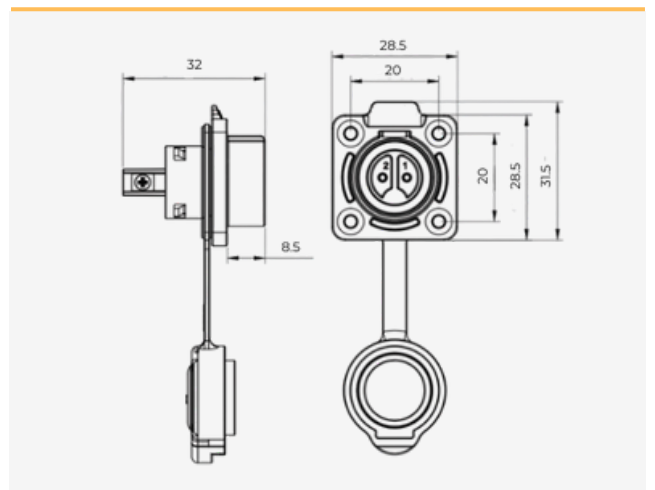

LP16 Series

IP68 Compact Quick Connect Plug & Sockets

Mounting Specifications

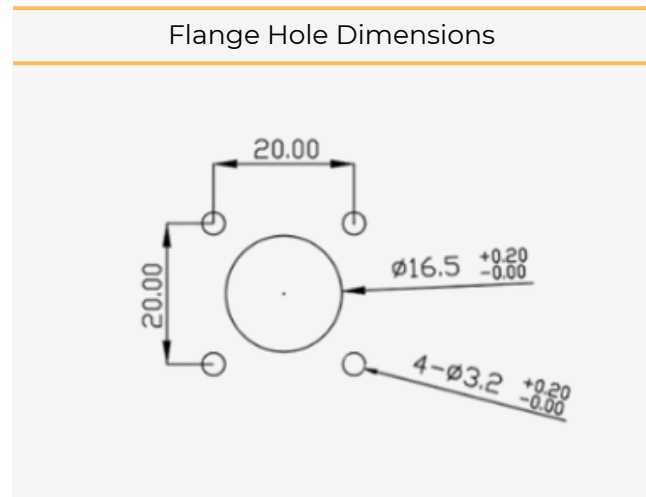
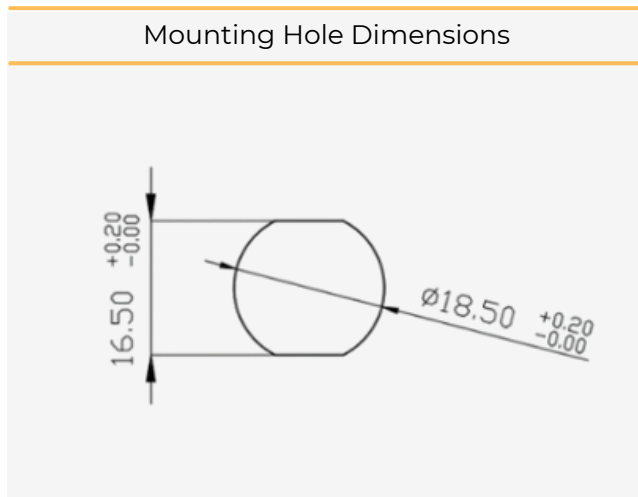

Part Number Configurator

Series:	LP16	Example:	LP16	02P	F	SC	ZZ	01
Number of Pins:	02P - 2 pins 03P - 3 pins 04P - 4 pins	05P - 5 pins 07P - 7 pins 08P - 8 pins	09P - 9 pins					
Mounting Type:	C - cable F - flange P - panel							
Connection Type:	SC - Screw SO - Solder							
Material:	PL - PBT ZP - PBT & Zinc Alloy ZZ - Zinc Alloy							
Polarity:	0 - Female panel & male cable 01 - Female cable & male panel							

LP16-02PF-SC-ZZ-01 - LP16 2 pin flange mount screw zinc alloy female cable male panel