

|                       |                      |  |   |
|-----------------------|----------------------|--|---|
| Rating                | 20A 12V DC           | <b>Mounting Hole</b><br>   | <b>Circuit Diagram</b><br><b>Circuit 1</b><br><br>ON : Green lighted<br>OFF : Red lighted R=680 ohm |
| Contact Resistance    | 50m ohm MAX.         |  |   |
| Insulation Resistance | DC 500V 100M ohm Min |  |   |
| Dielectric Strength   | AC 1500V 1 minute    |  |   |
| Operation Temperature | -20°C~85°C           |  |   |
| Switch Function       | 3P SPST ON-OFF (LED) |  |   |
| LED Color             | Red/Green            | <b>Circuit 2</b><br><br>ON : Green lighted<br>OFF : None R=680 ohm |   |

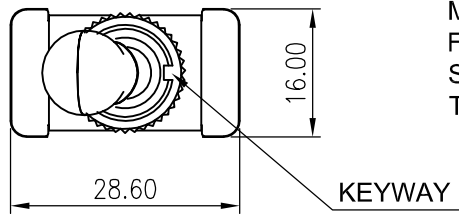

Material:  
Frame: Black, PF  
Sleeve-Toggle: White, PC  
Terminals: Copper Alloy

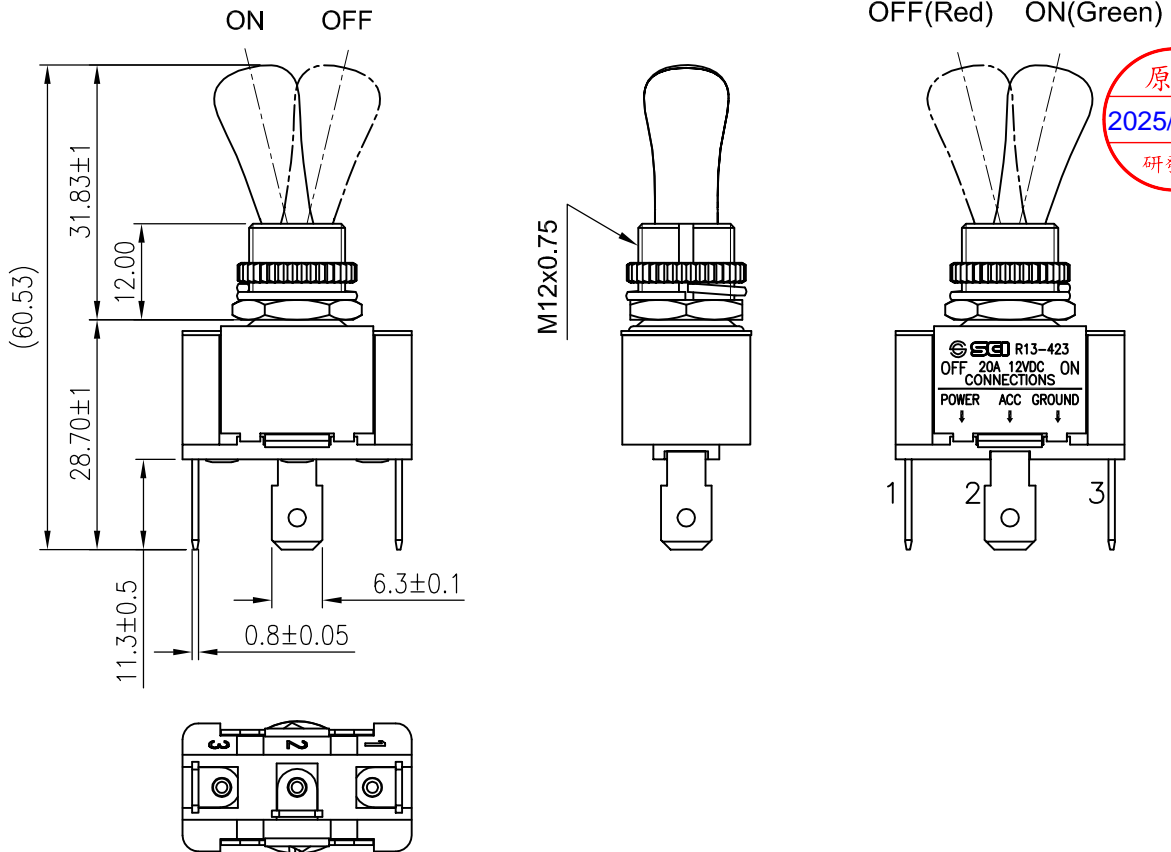

Tolerances ±0.3 Unless Otherwise Specified

|         |            |             |              |         |                                |                     |      |   |
|---------|------------|-------------|--------------|---------|--------------------------------|---------------------|------|---|
|         |            |             |              |         |                                |                     |      | △ |
|         |            |             |              |         |                                |                     |      | △ |
| Date    | Name       | Description |              |         |                                |                     | No.  |   |
| Drawn   | Checked    | Approved    | SCI BOM No.  | 1813881 | Model Name                     | TOGGLE SWITCH       |      |   |
| Ruby    | 陈列强        | 李理          | Customer No. |         | Model No.                      | R13-423L2-01-RG-HWR | Rev. |   |
| 2/27/25 | 2025/02/28 | 2025/02/28  | Unit         | mm      | Shin Chin Industrial Co., Ltd. |                     |      | 0 |