

ROCKER SWITCH MODEL:MR SERIES

RATING:12(4)A 125/250V~ (cURus/ENEC 15)

10(4)A 250V~ T125/55 (CQC)

DIELECTRIC WITHSTAND VOLTAGE:1500VAC FOR 1 MINUTE

INSULATION RESISTANCE:500VDC 100MΩ (MIN.)

CONTACT RESISTANCE: 20mΩ INITIAL (MAX.)

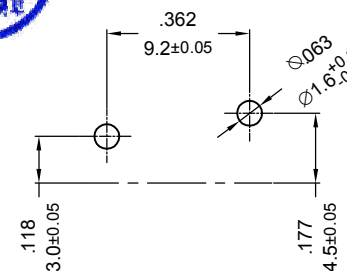
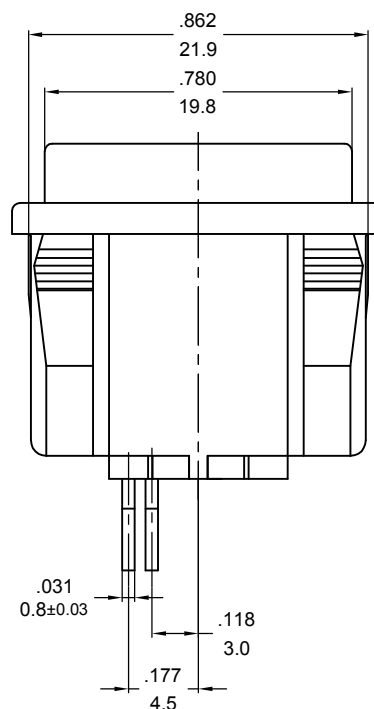

PCB MOUNTING HOLE ARRANGEMENT

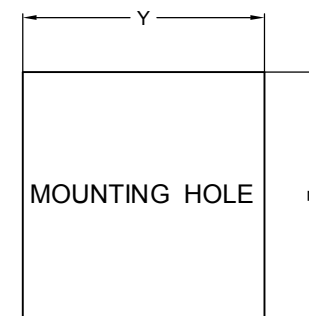

X= PANEL THICKNESS	Y	Z
0.8~1.2mm	19.2 ^{+0.1} ₋₀ mm	21.9 ^{+0.1} ₋₀ mm
1.3~2.0mm	19.4 ^{+0.1} ₋₀ mm	21.9 ^{+0.1} ₋₀ mm
2.1~3.0mm	19.8 ^{+0.1} ₋₀ mm	21.9 ^{+0.1} ₋₀ mm

NOTE: TOLERANCES UNLESS OTHERWISE SPECIFIED: ± .012/0.3 (in/mm)

PANEL CUTOUT DIMENSION TABLE

REVISION	DESCRIPTION	REVISED BY	TOLERANCES				ANGLE 1/2°	UNIT	mm	PART NAME	MR SPEC DRAWING		DWG NO
△			DRAWN BY	楊偉韶	DESIGNED BY	蔡劍	SCALE	2/1		PART NO			S9074A
△			CHECKED BY		APPROVED BY		DATE	2022.12.13		PART NO			
△	2022.12.13 首次出圖	楊偉韶									MR-112C5W-NBBB-1GNC		