

佳尼有限公司 CANAL COMPONENTS INC.

SPECIFICATION MODEL : PK SERIES

Rating: 6A 125/250V~ μ 5E4 (cURus/ENEC15)
 6A 3~48VDC μ 3E4 (cURus/ENEC15)
 Contact Resistance: 50m Ω (max.) initial
 Insulation Resistance: 100M Ω (min)
 Dielectric Strength: 500VAC for 1 minute
 Mechanical Life: 1,000,000 cycles
 Operation Force: 350g \pm 150g
 Shell Material: Stainless Steel
 LED Voltage: 6 VDC (WHITE)

Description of LED color and voltage :

PK-19Z23XEW2SS-ANTN



LED COLOR

N	NO COLOR
R	RED
G	GREEN
U	BULE
W	WHITE
Y	YELLOW

LED VOLTAGE

N	NO ILLUMINATED	2	DC 6V
L	AC 110V	3	DC 12V
G	AC 220V	4	DC 24V
1	DC 2V (Red, Yellow)	5	DC 30V
	DC 3V (Green, Bule, White)	6	DC 48V

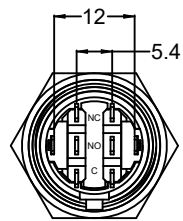
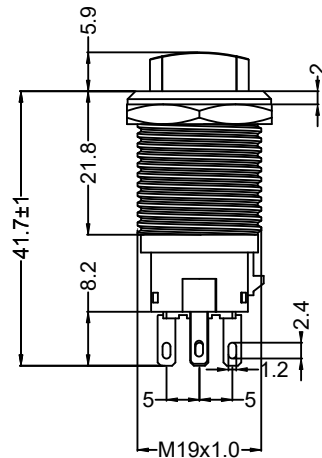
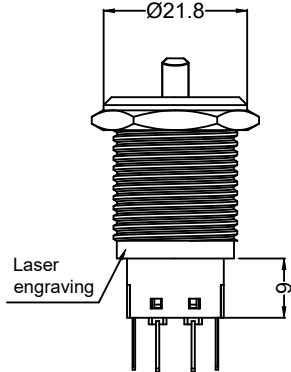
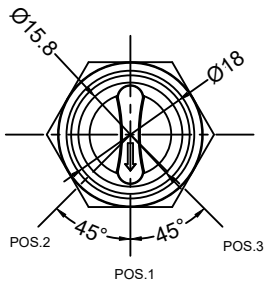
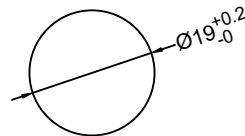
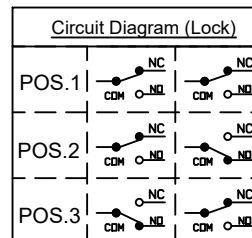
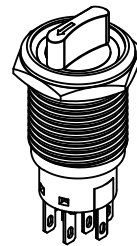

Accessories package	
Silicon o-ring	Hex nuts
Accessories are not locked when shipped	

Laser engraving

CANAL PK Series 6A 125/250V~ μ 5E4 cURus 15 6V/W

NOTE: TOLERANCES UNLESS OTHERWISE SPECIFIED : \pm 0.5 (mm).

REVISION	DESCRIPTION	REVISED BY	TOLERANCES	ANGLE $\frac{1}{2}^\circ$	UNIT	mm	PART NAME	SPEC DRAWING	DWG NO
			DRAWN BY 范修銓	DESIGNED BY 范修銓	SCALE	1/1	PART NAME	SPEC DRAWING	WS4828B
	料號變更, 原料號 PK-19Z23XEW2S-ANTN	范修銓	CHECKED BY ERIC	APPROVED BY	DATE	2021.12.20	PART NO	PK-19Z23XEW2SS-ANTN	
	首次出圖	范修銓							