

1

2

3

4

Notes: (Unless Otherwise Specified)
 1. Waterproof Rate: IP67.
 2. RoHS Compliant.

REV	ECN#	DESCRIPTION OF REVISION	DRAW BY DATE	CHECK BY DATE	APPROVE BY DATE
A0		Mass Production	Joyce 04/15/13	Lucas 04/15/13	Ray 04/15/13
A1	ECN-131117	Modified Screw Cap $\Delta A1$	Joyce 11/05/13	Lucas 11/05/13	Ray 11/05/13
A2	ECN-140101	Marked $\Delta A2$	Joyce 01/13/14	Lucas 01/13/14	Ray 01/13/14

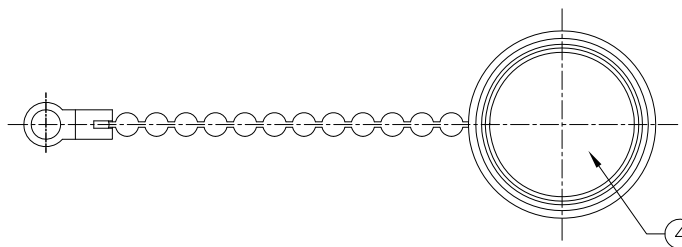
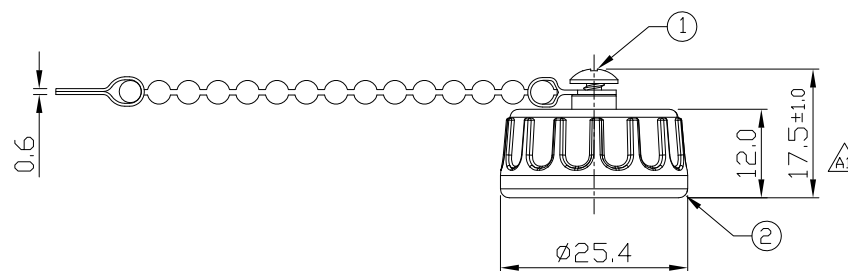
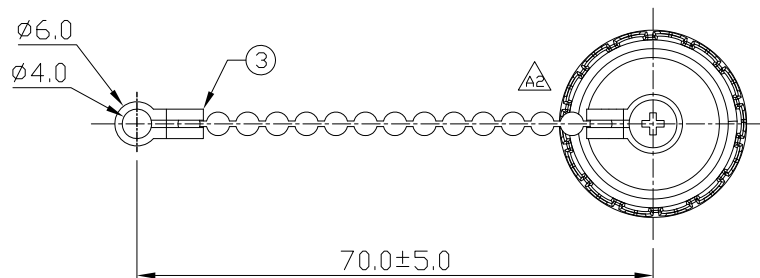

GTC
 DOC.CENTER.ISSUE
 JAN.17.2014
 ONLY FOR
 RELEASE

4	Rubber Pad	Silicone Color: Black	1
3	Metal Chain	Stainless Finish: -	1
2	Screw Cap	Thermoplastic Color: Black	1
1	Tapping Screw	Stainless Finish: -	1
Item	Part Name	Material / Finish	Q'TY

TITLE						DRAWING NUMBER			REV.
Cap Plastic For C3 Screw Panel With Metal Chain(M3 Screw)						GT1C533162			A2
	B	1:1	Joyce 04/15/13	Lucas 04/15/13	Ray 04/15/13	X.X ± 0.5 X.XX ± 0.2	X.XXX ± 0.05 ANGLES ± 1°	mm	1/1
THIRD ANGLE PROJECTION	SIZE	SCALE	DRAW / DATE	CHECK / DATE	APPROVE / DATE	TOLERANCES		UNIT	SHEET

GT Contact CO.,LTD

NOTICE OF PROPRIETARY PROPERTY:
 THE INFORMATION CONTAINED HEREIN IS THE PROPRIETARY PROPERTY OF GT Contact CO.,LTD THE POSSESSOR AGREES TO THE FOLLOWING:
 (a) TO MAINTAIN THIS DOCUMENT IN CONFIDENCE
 (b) NOT TO REPRODUCE OR COPY IT
 (c) NOT TO REVEAL OR PUBLISH IT IN WHOLE OR PART
 (d) ALL RIGHTS RESERVED

1

2

3

4