

Notes: (Unless Otherwise Specified)

1. Waterproof Rate: IP68.
2. Cable Diameter: 5.0 to 6.0 mm
3. Recommend Cover Torque: 6.0 to 7.0 Kgf-cm.
4. Recommend Gland Nut Torque: 9.0 to 10.0 Kgf-cm.
4. Matting No.: GT225200/GT225500 Series.
5. RoHS Compliant.

REV	ECN#	DESCRIPTION OF REVISION	DRAW BY DATE	CHECK BY DATE	APPROVE BY DATE
A0	ECN-140113	Mass Production	Joyce 01/29/14	Lucas 01/29/14	Roy 01/29/14

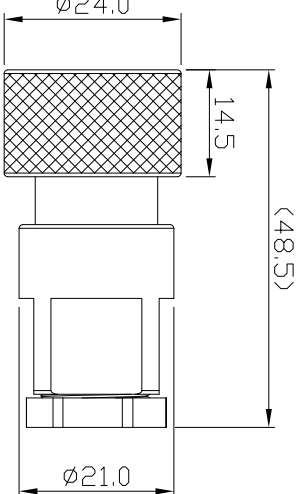
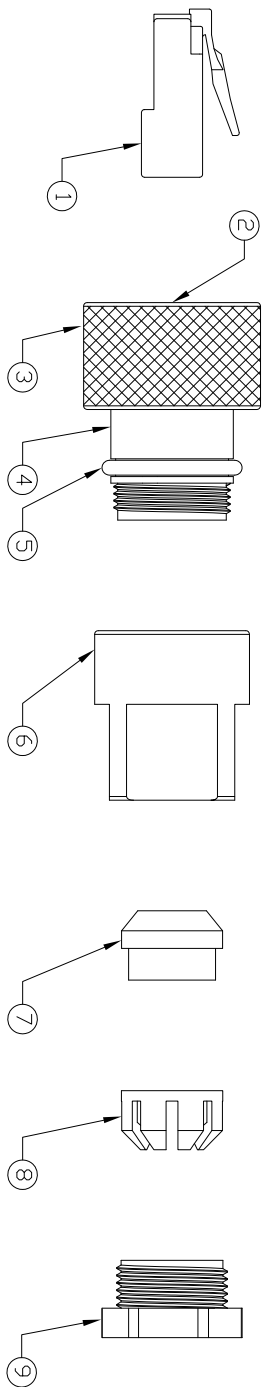

Item	Part Name	Material / Finish	Qty
9	Metal Gland Nut	Copper Alloy Finish: Ni Plated	1
8	Cage	Thermoplastic Color: White	1
7	Gland	Silicone Color: Green	1
6	Metal Cover	Copper Alloy Finish: Ni Plated	1
5	O-Ring	Silicone Color: Red	1
4	Housing	Thermoplastic Color: Black	1
3	Metal Screw Nut	Copper Alloy Finish: Ni Plated	1
2	Rubber Pad	Silicone Color: Black	1
1	RJ45 Plug	Housing: Thermoplastic, Color: Clean Contacts: Copper Alloy Finish: Au Plated Shell: SPCG Finish: Ni Plated	1

TITLE	DRAWING NUMBER	REV.
RJ45 Full Metal C3 Shielded Field Installable Cable End Screw	GT225370-00	A0

THIRD ANGLE PROJECTION	SIZE	SCALE	DRAW / DATE	CHECK / DATE	APPROVE / DATE	TOLERANCES	UNIT	SHEET
1	B	1:1	Joyce 01/29/14	Lucas 01/29/14	Roy 01/29/14	XX ± 0.5 XXX ANGLES ± 1°	mm	1/1

GTC  
DOC.CENTER.ISSUE  
JAN.29.2014  
ONLY FOR  
RELEASE

GT Contact CD, LTD

NOTICE OF PROPRIETARY PROPERTY:  
THE INFORMATION CONTAINED HEREIN IS THE PROPRIETARY PROPERTY OF GT Contact CD, LTD. THE POSSESSOR AGREES TO MAINTAIN THIS DOCUMENT IN CONFIDENCE AND NOT TO REPRODUCE OR PUBLISH IT IN WHOLE OR PART (S) ALL RIGHTS RESERVED